

Privacy fence w/ lattice top (and privacy 5+1) INSTALLATION GUIDE

September 2009

BEFORE YOU BEGIN

Ensure that you call your local authorities to get underground systems marked. This is simple and free, just call **811** or visit www.call811.com. Be sure to understand your property borders and avoid encroaching on neighbors land stake out your fence line with string.

ASSEMBLED FENCE – Standard size based on 8' on center (OC) posts

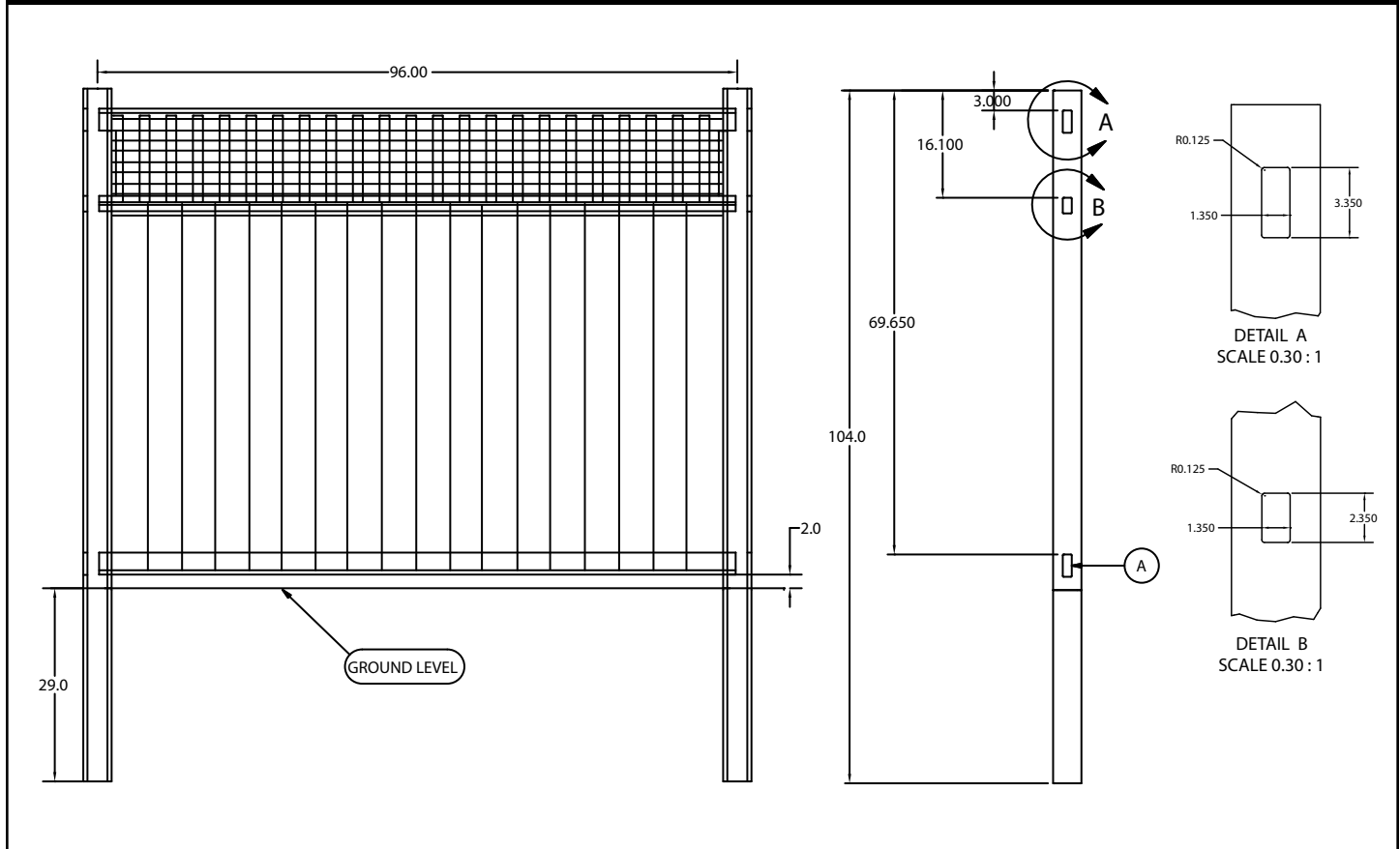

PARTS LIST FOR PRIVACY W/ LATTICE TOP

Part	Qty	Item
1	2	Full Privacy 5+1 Post
2	2	C-Channel
3	1	Pocket Rail
4	1	Pocket Rail with Steel
5	9	10-inch Tongue & Groove
6	1	H-Rail
7	1	Lattice
8	7	Deck Screws
9	6	C-Channel Screws

STEP 1: Dig post holes

Measure for your post spacing (typically it will be 96" on center OC when using *highwood* fence's standard pre-cut privacy components) and dig your post holes.

Holes should be minimum 12" in diameter; with straight edges and a depth of 36" (deeper if the frost line requires it).

6" of the hole should be filled with gravel for drainage below the post.

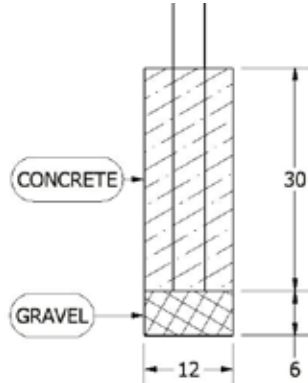

STEP 2: Install your 1st post

Center your post in the hole and check to ensure that the lower edge of the routed hole in your post (for the bottom rail) is 2" above grade.

Fill the hole with concrete; using a wet mix will give best results tamp around the base to remove any air pockets in the concrete.

Ensure that the post is vertical AND square to your next post position.

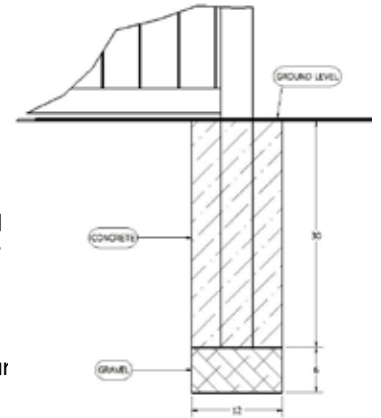

STEP 3: Insert bottom rail & next post

Your bottom rail comes with steel pre-installed to give extra strength.

Simply slide one end into your 1st post and drop the next post into the hole so that the rail sits between the two posts.

It is extremely important to get the post spacing accurate if you wish to avoid the task of trimming pickets.

With 95.5" rails, the posts must be exactly 96" on center (OC) no more.

If the posts are closer or not vertical, you may have to trim a picket to fit.



STEP 4: Continue installation

Complete this process along the entire line of the fence, being sure that your posts are vertical and square to the next post and that they are max 96" OC.

Check this one final time before leaving the concrete to set.

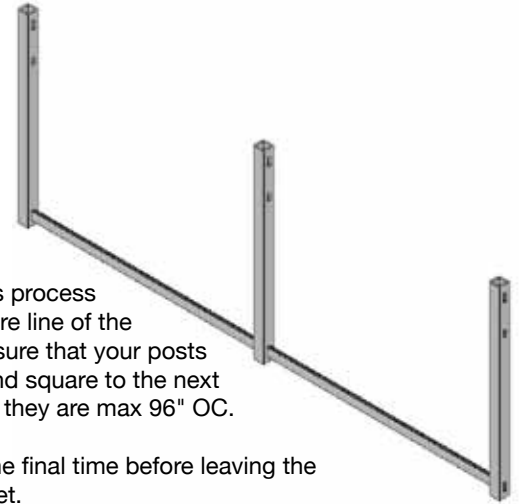

STEP 5: Cut C-Channels and screw into posts below the mid-rail

THIS IS NOT AN OPTIONAL STEP and failure to install the C-Channel will void the warranty of the *highwood* fence.

Cut your C-Channel to fit neatly either side of the routed hole for the middle rail (above and below it).

A minimum of 3 screws should be used (top middle bottom) for the larger (bottom) piece of C-Channel.

Line the C-Channel up in the center of the post and between your routed post holes – screw in firmly, your pickets will sit inside this C.

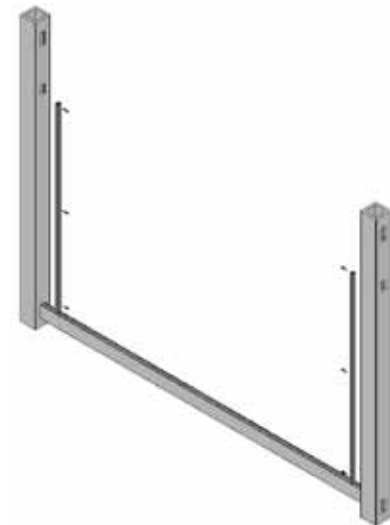

STEP 6: Insert the interlocking pickets

The lattice-top panel comes with pre-cut pickets (53-3/8") with interlocking T&G design.

Starting at one end of the panel, carefully slide these pickets down into place ensuring that the 1st picket is inside the C-Channel and flush with the post.

If your post spacing is less than 96" OC, the final picket can carefully be ripped to fit the gap... be sure that just like the 1st picket, this fits neatly down inside the C-Channel and is flush with the post.

Note that if you are installing privacy 5+1 (T&G pickets above & below the middle rail, no lattice) you will need to cut down your standard privacy length pickets (67.5") to fit above and below the middle rail.

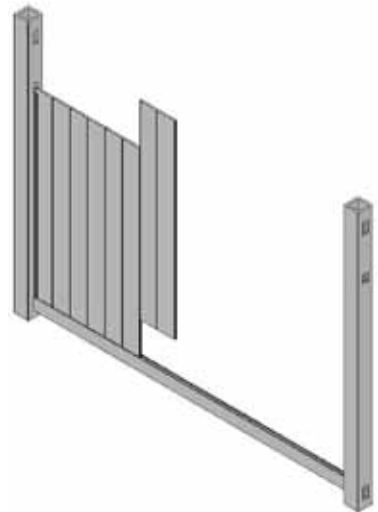

STEP 7: Drop the middle rail into place & screw down into the middle 5 pickets

Slide the middle rail into your 1st routed post hole and carefully lower it down over the T&G pickets before sliding the other end of the rail into your next post hole ensure that this rail is central (equal amount inside each post).

To secure the middle rail to the T&G pickets (providing stability & reducing the chance of bottom rail sag) use the supplied deck screws and screw down through the open pocket of the middle rail into the center of the middle 5 pickets.

Aim the screws at the center of each picket and these screws will bite into the picket inside the middle rail channel.

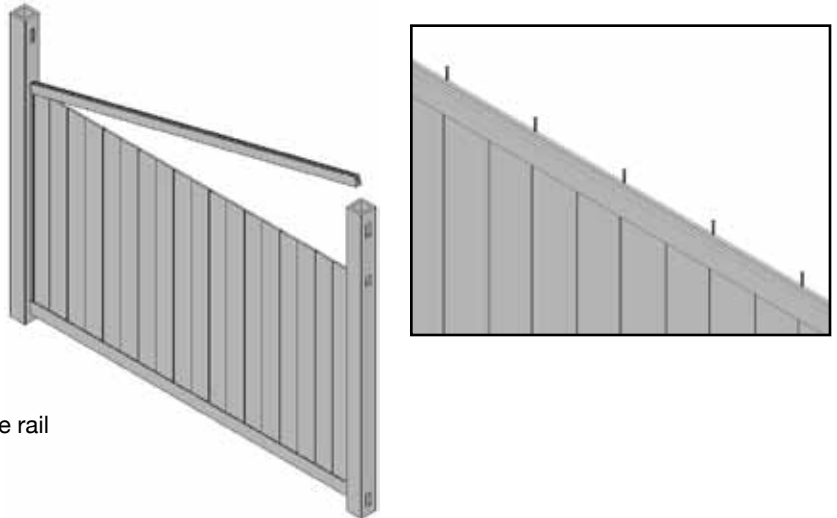

STEP 8: Insert the smaller C-Channel pieces & your lattice

Now install your smaller C-Channel piece between the middle rail and the routed post hole for the top rail.

Be sure to place the C-Channel in the center of the post and use 2 screws (supplied) to secure into place.

Your pre-cut lattice should now slide down into the side C-Channel and also into the channel of the middle rail providing a secure frame for the lattice.

If your panel is less than 96" OC, you can of course carefully trim the lattice to fit.

If inserting more pickets (5+1 application) as opposed to lattice, this stage is simply a repeat of step 6 using shorter pickets to fill the gap between each post.

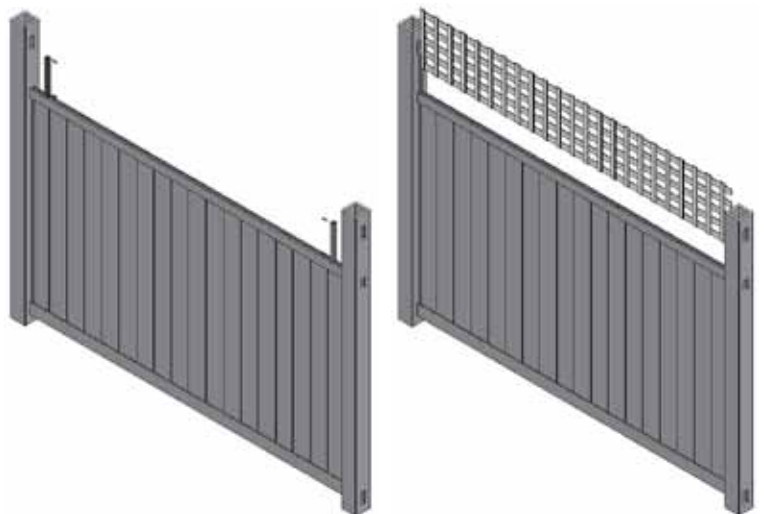

STEP 9: Insert the top rail, center it and secure the ends

Carefully insert one end of the top rail into your 1st post hole and lower it over the lattice, be sure that the lattice is fully inserted into the rail channel and then slide the other end of the rail into the 2nd post hole.

Center the rail (look down inside the posts to see the rail ends) so that an equal amount of rail is in each side.

Using the remaining deck screws (provided) insert one screw down into the rail inside the post at each end (Approx 1/4" from the end of the rail leaving 1/2" to 3/4" of the screw sticking out).

This will secure the rail in place and, if you ever need to replace a picket, simply remove the screws and slide the top rail/components out.

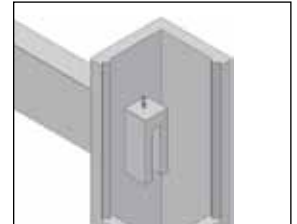
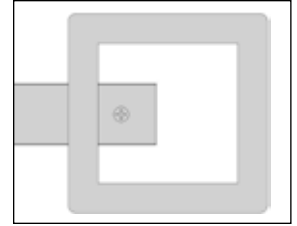

STEP 10: Secure the post caps

Drop your *highwood* post caps into place to finish the job.

These caps do not require adhesive and by not gluing the caps you will keep the option to access the top rail screws and remove that rail/pickets at any time in the future.

However, if glue is preferred, solvent based (Testers 3501GA/3503GA / 3521GA or IPS Weld On #116) or solvent free (3M Scotch Weld #TE031 / 3M Jet Melt #3764 / Tite Bond #5492 / 3M Super 77) will work fine.

Take care as solvent bases can run/drip and alter the look of the *highwood* material.

STEP 11: Installing gates

Highwood privacy fence pre-assembled gates (available in standard 3/4/5' widths and also custom sizes on request) are the only gates that carry the *highwood* warranty and should be matched with D&D Technology's hardware which is supplied WITH the gate.

When installing a double drive gate D&D latch bolts are available with floor plates and our gates are made up to 5' in width allowing a 10 foot wide opening.

Be sure to use the supplied hardware screws to secure the hardware into the *highwood* material you will notice that highwood has excellent screw retention and allows a tight connection of the hardware.

